

Control Instruction

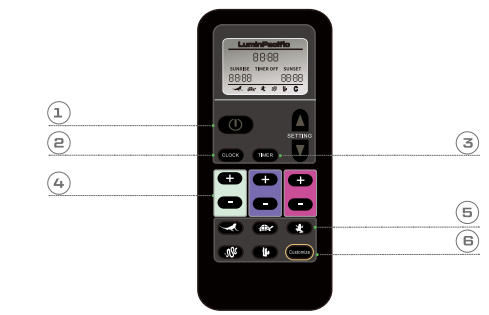

- 1 ON/OFF Button
- 2 CLOCK Button[To set the current time]
- 3 TIMER Button[To set the sunrise and sunset time]
- 4 DIM Button[To adjust the each channel's intensity of W+UVA+UVB+FR]
- 5 Preset Spectrum
- 6 Customize Spectrum

Note: Battery not included. 2xAAA alkaline batteries are required.

CLOCK Setting

Picture	Procedure	Picture	Procedure
	Press the CLOCK , the screen will flash the hour number. Then please use arrow ▲/▼ to adjust the hour time.		Then click the CLOCK again, the screen will flash the minute number. Please use arrow ▲/▼ to adjust the minute. Once the minute time is set, click the CLOCK to save the current time.

Note: During the CLOCK setting, it is not allowed to adjust any of the other parameters, unless you have completed the CLOCK setting.

TIMER Setting

Picture	Procedure	Picture	Procedure
	Press the TIMER , the screen will flash the hour number of SUNRISE. Then please use the arrow ▲/▼ to adjust the hour time.		Then click the TIMER again, the screen will flash the minute number of SUNRISE. Click the TIMER again to set the hour and minute of SUNSET in the same way as SUNRISE. Once the TIMER SUNRISE and SUNSET times are set, click the TIMER to save the time.

Note: 1/During the Timer setting, it is not allowed to adjust any of the other parameters or to exit the Timer mode unless you have completed the Timer setting.
2/When the screen shows timer off, press and hold the **TIMER** to enter timer mode to set the sunrise and sunset time. When the screen shows sunrise and sunset time, press once **TIMER** to change the sunrise and sunset time.
3/In timer mode, sunrise (ramp up) and sunset (ramp down) period is designed to be 10-minute. i.e: Sunrise at 8:00 and Sunset at 17:00. The device will run into sunrise at 8:00 and ramp up to the full brightness for daylight spectrum at 8:10, and start sunset period from 16:50 and switch to moonlight spectrum at 17:00.
4/Dimming and mode switch operations are not allowed during the sunrise and sunset period. Although the remote control will display your operations in the sunrise and sunset period, the light will not respond.

Preset Spectrum Setting

Picture	Procedure	Note: 1/If you change the intensity for each channel by pressing + / - in preset mode, the icon displayed on the screen will disappear. 2/Spectrum Configuration:	
	Press 5 preset spectrum button to select and apply your desired mode, the icon of your selected mode will be displayed on the screen.	W+UVA 100% UVB 90% FR 80%	W+UVA 80% UVB 60% FR 50%
		W+UVA 50% UVB 30% FR 20%	W+UVA 30% UVB 10% FR 50%
		W+UVA 80% UVB 60% FR 20%	

Customize Spectrum Setting

Picture	Procedure	Note: 1/If the light flash after you press and hold + / - , it indicates that the customize spectrum has been saved. <u>If the customize spectrum is set with 0% brightness of W+UVA channel, the light will not flash even if the customize mode is successfully configured.</u> 2/Press once to increment or decrement by 10%, press and hold to increment or decrement by 1%. The intensity can be dimmed to 0%.
	Press + / - to adjust each channel's intensity to your desire. Then press the Customize for 3 seconds to save the customize spectrum.	

Tips

- Only "Timer OFF" is shown on the remote screen when the Timer mode is off.
- When the light is in auto mode, you can set the daylight spectrum in daytime and set moonlight spectrum in nighttime.
- Please note that the moonlight spectrum cannot be set up during the daytime.
- When you save the customize spectrum, the light will flash to indicate successful setting.
- During the CLOCK setup, it is not allowed to adjust any of the other parameters, unless you have completed the CLOCK setup.
- During the Timer setup, it is not allowed to adjust any of the other parameters or to exit the Timer mode unless you have completed the Timer setup.

FAQ

- 1/How to deal with the first use of the UVB reptile light that does not light up?**

 - Check that the power supply and the DC plug on the light side are in normal connect.
 - Make sure the remote controller is installed with 2xAAA alkaline batteries and switch the light to ON status.

2/How to determine whether the UVB light needs to be replaced?

This card is intended for rough UVB testing, and the lizard icon will change color after testing at a further suitable distance. Please test the UVB output regularly.
- 3/Why cannot control the light via the remote controller?**

Please check if the remote controller has any display. If not, please kindly try to replace two new batteries. Importantly, please make sure the remote control is pointed at the light during the operation.

4/How to solve the problems in using the UVB reptile light?

Feel free to reach out to us via email, and we'll address your problems as soon as we receive your message.

Installation Guide

Method 1 (For wooden terrarium):

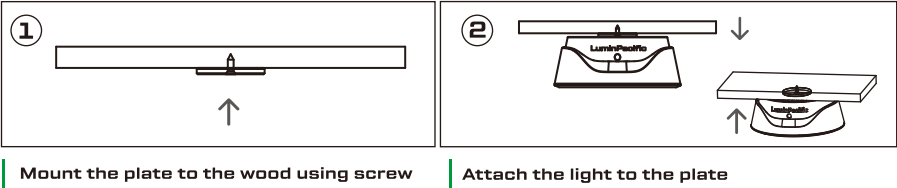

Method 2 (For normal terrarium):

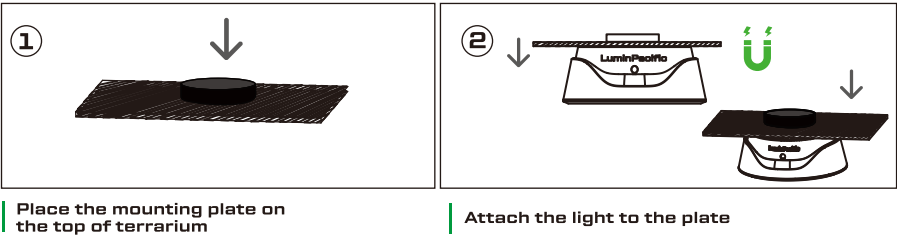
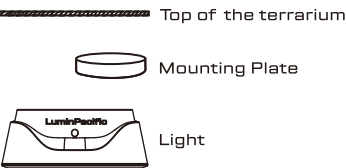

Method 3:

